

Observation of Instructional Behaviors

TEACHER _____ OBSERVER E

DATE 11/29/12 BEGINNING TIME 8:05 ENDING TIME _____

(In the following box, make a sketch of the classroom. Include the desks or tables and the teaching area.)

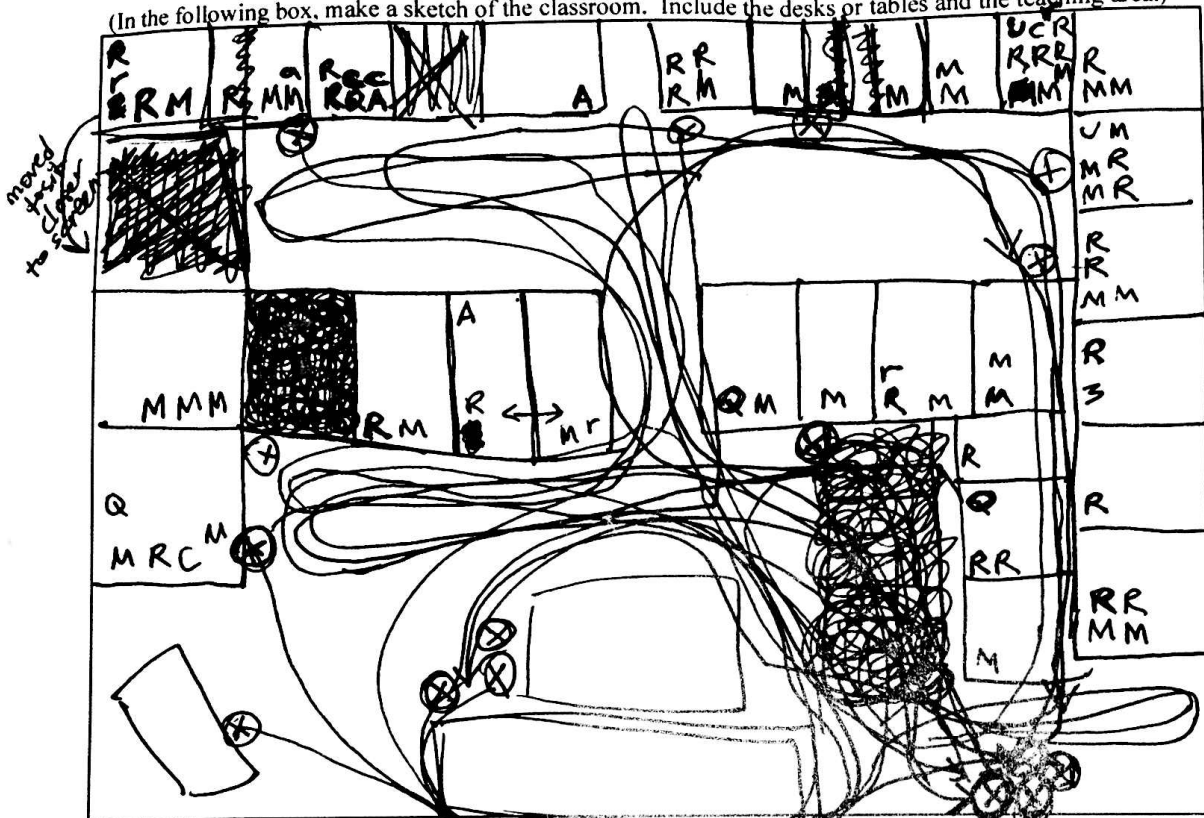

ALL STUDENTS RESPOND:

(Tally responses by category.)

Q - partner 1 - very rich discussion evident
 Write |||| (2/27 Do Now)
 Other _____ (10/27 Write Difference)

INDIVIDUAL RESPONSES:

(Record "R" on the "desk".)

(After the lesson, record number of individual responses and total.)

R = tried to answer follow up Q

Individual Responses ~~||||~~ 33

TOTAL # OF RESPONSES 42

MONITOR:

(Record M on "desk" if the teacher stops and looks at the student's work or in any other way interacts with the student.)

ACKNOWLEDGMENT, PRAISE, POSITIVE COMMENTS:

(Tally comments given to class or individuals.)

|||| "Wow! (Very good!)"
 & paraphrasing

- Q = Asked Q
- ⊗ = Stopped @ Desk

U = unrelated response

A = Read Aloud a = supported another reader

C = Called out a response

Attention Getters (5)

- Clapping ||
- Show Me w/ Your Fingers ||
- Thumbs Up |